



**AUDIO**



**RAGER-WPA-3.1 INSTRUCTIONS**



**D/A AUDIO** TRUE TO THE SOURCE.®

4025 NW 36th St., Oklahoma City, OK 73112 • (405) 239-2800

DDAUDIO.COM



Thank you for purchasing a DD AUDIO® RAGER. All of our products are proudly developed at our headquarters in Oklahoma City, USA where day in and day out we dedicate ourselves to the mission of providing our customers with products that meet or exceed our stringent standards of reliability and performance. All of our products are painstakingly designed to provide years of listening pleasure.

We hope you enjoy using this DD AUDIO product, and if you have any questions regarding setup or installation after reading this manual, please contact the DD AUDIO technical support team.

## SPECIFICATIONS

Watts RMS: .....	120
Watts Peak: .....	240
VCD (In): .....	1.5
Tweeter VCD (In): .....	1
Frequency Response (Hz): .....	60 - 20k
Fs (Hz): .....	60
dBSPL: .....	97
Dimensions (Inches): .....	13 x 10 x 12
Dimensions (mm) .....	330.2 x 254 x 304.8
Shipping Weight (Lbs): .....	18
Shipping Weight (KG): .....	8

**Instructional Video RAGER-WPA-3.1:**  
<https://youtu.be/A9PtGzMn89M>

**RAGER-WPA-3.1**  
 Instructional  
 video



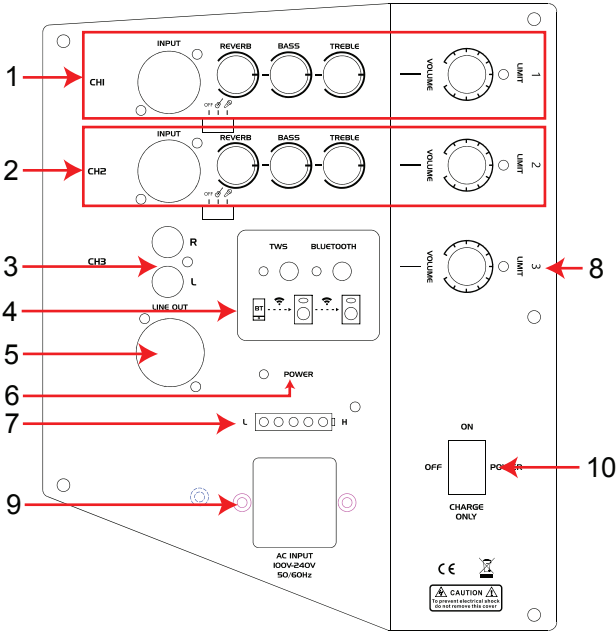

## 1 & 2: Channel 1 and 2:

**INPUT:** XLR or 1/4" (balanced signal) channel LINE IN.

**REVERB:** Use it to set the REVERB.

**BASS:** Use it to set the BASS.

**TREBLE:** Use it to set the TREBLE

**VOLUME:** Use it to set the VOLUME LEVEL.

**LIMIT:** Clipping Indicator Light. If light is blinking turn it down.

**OFF/MIC/Guitar:** Use it to switch between MIC and Guitar.

3. **Channel 3:** RCA input: Use it to input RCA connector.

4. **Wireless Connectivity Section:**

**TWS:** Pairing Switch

**Bluetooth:** Wireless Connectivity Switch

5. **LINE OUT:** XLR (balanced signal) channel LINE OUT.

6. **POWER:** Power indicator light.

7. **Battery Indicator Light:** When lit the device is ON.

8. **Volume:** Control Wireless and Ch 3 volume level.

**LIMIT:** Clipping Indicator Light. If light is blinking turn it down.

9. **Power Supply Input Connector:** Used to connect to Power cord.

10. **Power Supply Switch:** Turn OFF/ON or set to Charge mode.

## CONNECT WIRELESSLY

1. To connect wirelessly, turn on the speaker. At this time go to the wireless settings on your phone as well.
2. Press bluetooth button on the speaker once and the blue light will start blinking.
3. Look on your phone's wireless settings and wait for the RAGER-WPA to appear, once it appears, select the Ranger-WPA on your phone to connect to it. Once connected the blue light will now be constant.
4. To sync two RAGERS wirelessly, power on both speakers, press the bluetooth button on both, followed by the TWS button on both. Wait for them to sync. Once synced, each speaker will announce which side is the left channel and which side is the right channel (ensure volume is turned up).
5. Once the same two speakers have been paired, the next time you want to pair them, make sure both speakers are on and all you need to do this time is push the bluetooth button once on both speakers to sync. Once synced, each speaker will announce which side is the left channel and which side is the right channel (ensure volume is turned up).

1



2

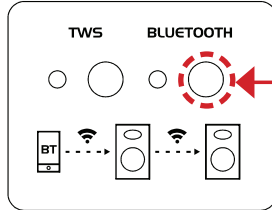

3

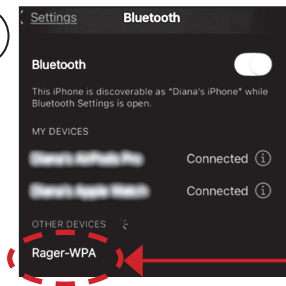

4

