

M8000, M5000, M2500, Z12000 (2023 VERSIONS)



M8000, M5000, M2500, Z12000 (2023 VERSIONS)

## INCLUDED IN KIT:

---

- Power Terminal PCB
- Input Signal PCB
- (2) Wire Harnesses
- (2) M4 Screws

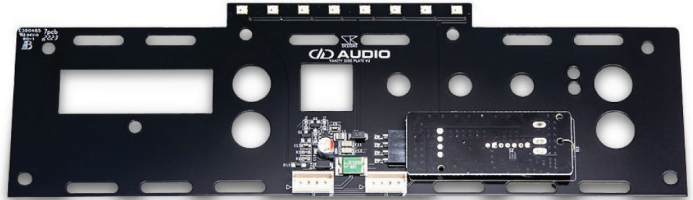

## TOOLS NEEDED:

---

- Phillips screwdriver
- 7/16 Wrench or Socket
- 2.5mm Allen Wrench
- Small Zip Ties
- A semi soft work surface to protect the amplifier heatsink from scratches.
- Cardboard, foam, or bubble wrap will do just fine.

**This procedure is to be performed prior to installing the amplifier into an audio system. If your amplifier is already installed in a system, uninstall it and disconnect all connections before performing the installation of the LED vanity plate kit.**

M8000, M5000, M2500, Z12000 (2023 VERSIONS)

## LED VANITY PLATE KIT INSTALLATION:

### BEFORE END PLATE REMOVAL



1. Remove all socket cap hex screws from the power terminal side of the amplifier and remove the end plate.
2. Place the power terminal side PCB against the heatsink with the “**TO LED PCB**” plug facing inward. Place the end plate over the PCB, align the mounting holes, and replace the screws.

### AFTER END PLATE REMOVAL

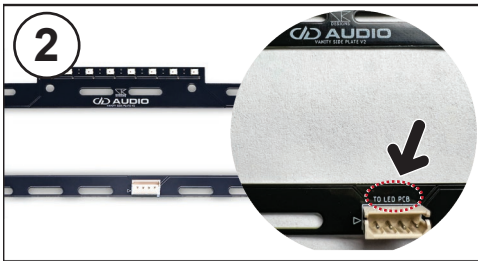

### PCB AND ENDPLATE



## M8000, M5000, M2500, Z12000 (2023 VERSIONS)

### BEFORE END PLATE REMOVAL



3. Remove the socket cap hex screws and 7/16 RCA nuts from the signal input side of the amplifier and remove the end plate.

### AFTER END PLATE REMOVAL



4. Place the input signal side PCB against the heatsink with the “TO LED PCB” and “TO MAIN PCB” plugs facing inward. Place the end plate over the PCB, align the mounting holes, and replace the screws.

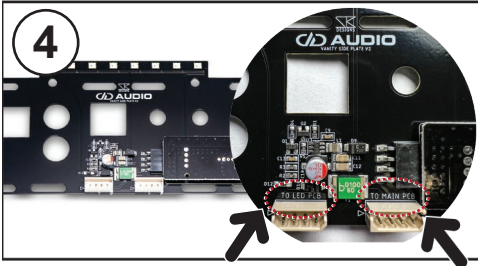

### PCB AND ENDPLATE



## M8000, M5000, M2500, Z12000 (2023 VERSIONS)



5. Flip the amp upside down, remove the phillips head screws securing the back plate. Carefully remove the back plate and disconnect the fan plug from the main internal pcb.

### SIGNAL INPUT PCB

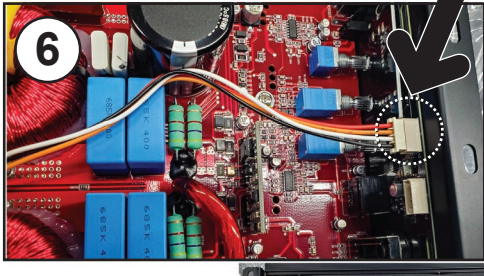

6. Using a provided wire harness, connect the signal input pcb to the main internal pcb using the “TO MAIN PCB” plug.

### MAIN PCB

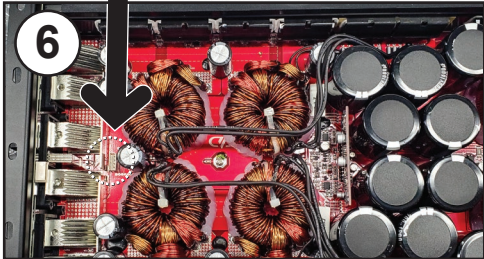

M8000, M5000, M2500, Z12000 (2023 VERSIONS)

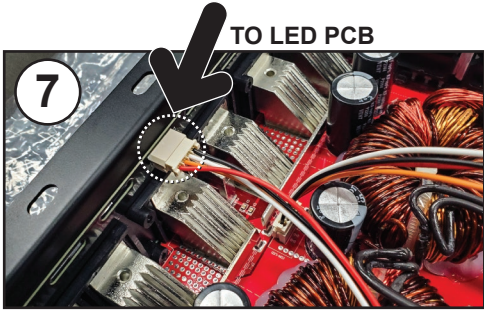

- 7. Using a provided wire harness, connect the power terminal pcb to the signal input pcb using the “TO LED PCB” plugs.
- 8. Using a couple small zip ties, tidy up the extra wire by routing them to the sides of the amplifier. This will ensure that the back plate is able to fully seat against the heatsink when reattached. After tidying up the LED kit wires, reconnect the back plate fan wire and reattach the back plate to the heatsink.



M8000, M5000, M2500, Z12000 (2023 VERSIONS)



9. Flip the amplifier over so that the logo is facing upward. Remove the two flathead screws from the top of the heatsink using a 2.5mm Allen wrench. Wipe or blow away any dust or debris that may have settled in the center section of the amplifier heatsink during installation of the PCB end panels.



10. Carefully unwrap the acrylic vanity plate and peel away the protective paper coating from the top face. Place the acrylic vanity plate into the center section of the amplifier heatsink and secure it to the heatsink with the two M4 button head screws provided in the kit.



Your amplifier is now ready to be installed into your sound system!

M8000, M5000, M2500, Z12000 (2023 VERSIONS)

## LED VANITY PLATE KIT OPERATION:



1. Navigate to your phone's app store and download the LED Hue app.



2. Once installed, open the LED Hue app. The LED Hue app will request permission to utilize Bluetooth®. Permission must be allowed in order to control the LED Vanity Plate Kit.

3. Power on your amplifier.

4. Within the LED Hue app a list of available Bluetooth® devices will be displayed. If no devices are present, drag down and release to refresh the list. Within the list of available devices, select "SP110E". The LED Hue app will attempt to pair to the SP110E device.

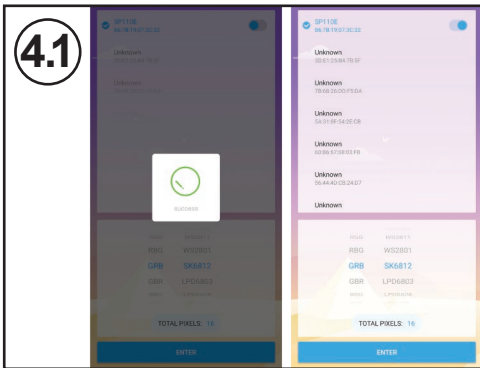

4.1 Once paired and connected, the SP110E device will be displayed at the top of the list in blue text. Use the toggle switch on the right side of the screen to turn the LED lights on or off.



M8000, M5000, M2500, Z12000 (2023 VERSIONS)

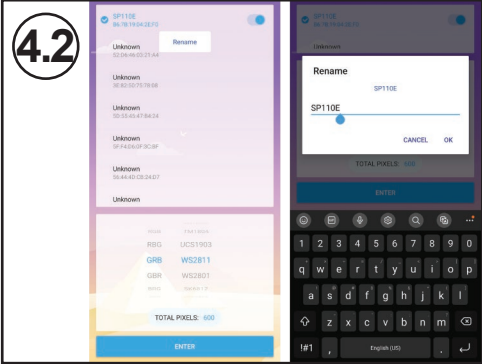

4.2 Press and hold on the SP110E device briefly and select the 'Rename' button that pops up. Rename SP110E to a device name that makes sense for your application, e.g. M8000, M5000, M2500. If multiple of the same amplifier are present in the system it is recommended to name them accordingly, e.g. M8000\_01, M8000\_02, etc.

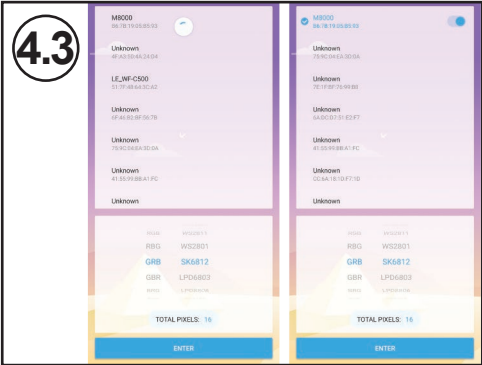

4.2 Once renamed, refresh the device list once more and select the device that was renamed in the previous step to reconnect.

4.4 Using the bottom section of the LED Hue app screen, assign the device the proper LED control protocol by selecting "GRB SK6812", set "TOTAL PIXELS" to **16 for M Series** or **20 for Z12000**, and press Enter.



**16 px for M Series / 20px for Z12000**

M8000, M5000, M2500, Z12000 (2023 VERSIONS)

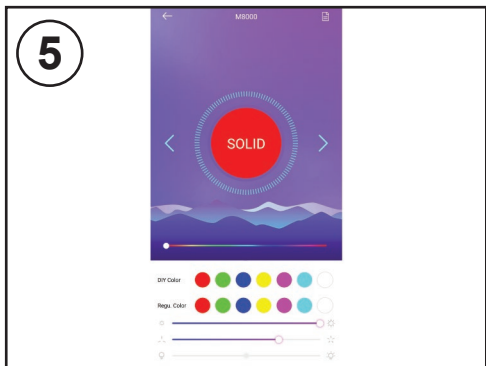

5. The LED Vanity Kit is now set up and ready to use. For more information on how to achieve a desired look, tap the tabbed sheet icon in the top right corner of the control screen of the LED Hue app. This will open a list of instructions on how to toggle through the various effects and colors available.

**Note:** If utilizing multiple amplifiers in a single audio system, repeat steps 1 through 4.4 for each amplifier. Due to a limitation in LED Bluetooth® technology, each amplifier must be connected to and programmed individually by the via LED Hue app device list. Each amplifier will retain its given device name and chosen color/effects pattern when power cycled.

---

If you have any questions regarding setup, installation or warranty please contact the DD AUDIO technical support team by email at [service@ddaudio.com](mailto:service@ddaudio.com) or by phone at (405) 239-2800.

Amplifier Vanity Plate instructional video url:  
<https://youtu.be>

Scan QR code with  
phonecamera for  
Amplifeir  
Vanity Plate  
Instructional Video.

